

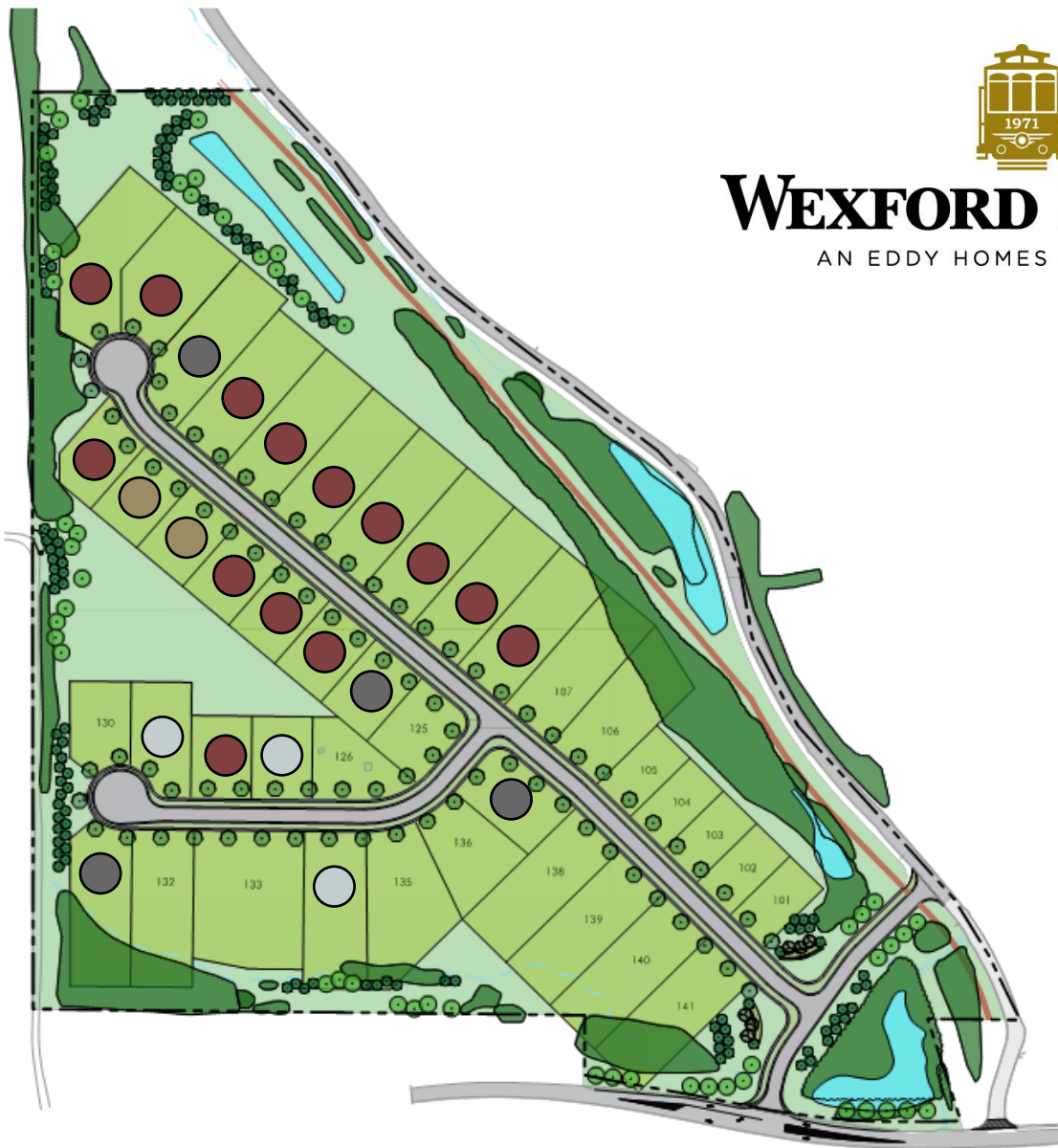

WEXFORD STATION

AN EDDY HOMES COMMUNITY



(M) Furnished Model

● SOLD

● Homesite Reservation

○ Quick Move-In Home

● Not Available

Discover Wexford Station

The possibilities are endless at Wexford Station, our highly anticipated, low-maintenance community in Pine Township. Located at the intersection of Route 910 and Brennan Road, Wexford Station puts you in the heart of everything Wexford has to offer, with easy access to I-79 and Route 19, local shopping, recreation, and so much more. This luxury community features 41 exceptionally designed homes and our most thoughtfully crafted floor plans, with layouts designed with you in mind. With the highest quality building materials and a Home Owner's Association responsible for yard maintenance, grass cutting and snow removal, Wexford Station merges convenience and luxury for the lifestyle you deserve.

EDDY HOMES

EST. 1971

wexfordstation@eddyhomes.com 888.805.EDDY
eddyhomes.com/wexfordstation

Wexford Station Homesite Guide

Homesite 101

Walkout Basement
Front Entry Garage - Left
***Restricted Model Depth 53'**
First Floor Master Required

Homesite 102

Walkout Basement,
Front Entry Garage - Left
***Restricted Model Depth 64'**
First Floor Master Required

Homesite 103

Walkout Basement,
Front Entry Garage - Left
***Restricted Model Depth 65'**
First Floor Master Required

Homesite 104

Walkout Basement,
Front Entry Garage - Left
***Restricted Model Depth 55'**
First Floor Master Required

Homesite 105

Walkout Basement
Front Entry Garage - Left
***Restricted Model Depth 56'**
First Floor Master Required

Homesite 106

Walkout Basement, Garage Left

Homesite 107

Walkout Basement, Garage Left
***Restricted Model Depth 71'**

Homesite 108

SOLD

Homesite 109

SOLD

Homesite 110

SOLD

Homesite 111

SOLD

Homesite 112

SOLD

Homesite 113

SOLD

Homesite 114

SOLD

Homesite 115

SOLD

Homesite 116

SOLD

Homesite 117

SOLD

Homesite 118

SOLD

Homesite 119-TOP SOIL

Buried Basement, Garage Right
First Floor Master Required

Homesite 120-TOP SOIL

Buried Basement, Garage Right
First Floor Master Required

Homesite 121

SOLD

Homesite 122

SOLD

Homesite 123

SOLD

Homesite 124-Lot Deposit

Walkout Basement, Garage Right
First Floor Master Required

Homesite 125

Walkout Basement, Garage Right
First Floor Master Required

Homesite 126

Buried Basement, Garage Optional
Right or Left
***Restricted Model Depth 72'**
First Floor Master Required

Homesite 127-Petersbrg SPEC

Buried Basement, Garage Left
First Floor Master Required

Homesite 128

SOLD

Homesite 129-Baywood SPEC

Buried Basement, Garage Left
First Floor Master Required

Homesite 130

Buried Basement, Garage Left
First Floor Master Required

Homesite 131-Lot Deposit

Walkout Basement, Garage Right
***Restricted Model Depth 62'**

Homesite 132

Walkout Basement, Garage Right
***Restricted Model Depth 70'**

Homesite 133

Existing Dwelling

Homesite 134-Victoria SPEC

Walkout Basement, Garage Left

Homesite 135

Walkout Basement, Garage Left

Homesite 136

Walkout Basement,
Front Entry Garage - Left
First Floor Master Required

Homesite 137-Lot Deposit

Walkout Basement,
Front Entry Garage - Left
First Floor Master Required

Homesite 138

Walkout Basement,
Front Entry Garage - Right

Homesite 139

Walkout Basement, Garage Right

Homesite 140

Walkout Basement, Garage Right

Homesite 141

Walkout Basement, Garage Right